



QF-405

Foam underlayment for floor assemblies

QuietFoam is a specially designed 3/8" closed cell polyethelene foam designed to reduce footfall and other impact noise on hardwood or tile floors.



Superior Acoustical Performance

QuietFoam, composed of a lightweight, closed cell, extruded polyethylene foam, is acoustically engineered to isolate sound vibrations and impact noises. Wall performance will also increase, as flanking noise will be reduced. Commercial applications, such as hotel rooms, conference rooms and townhomes/condominiums as well as residential applications like home theaters or laundry rooms are ideal areas for treatment.

Durable Material Composition

QuietFoam has exceptional compressive strength, while also being resilient enough to absorb impact vibrations. It will retain its acoustic properties over time while also being resistant to moisture, mold and fungus.

Fast, High Quality Installation

QuietFoam is lightweight, easy to cut and install. Installed beneath 1-1/2" gypsum concrete or a minimum of one layer of 7/16" OSB and finished flooring, QuietFoam isolates and minimizes structure-borne noise from transferring to adjacent areas or rooms. Refer to assembly instructions for complete installation information.

Design Considerations

QuietFoam is to be placed between the subfloor and OSB, backerboard, or gypsum concrete overlayment to create an isolation layer for sound vibrations and impact noises such as foot traffic. The plywood or gypsum concrete overlayment, once installed, "floats" on top of the floor mat providing a rigid surface for the finished flooring.

Tested Designs

While QuietFoam can be used with virtually any flooring system, it was specifically designed for use as part of a floor-ceiling assembly using QuietWood and QuietRock for STC's of 55-65 and IIC ratings of 50-65 depending on configuration. Other assemblies will have different STC and IIC results.

Fire Safety & Applicable Standards

QuietFoam has been tested in accordance with ASTM E-84 with resulting flame spread/smoke developed indices of 20/250, which meets the requirements for a Class A rating. Thermal barrier requirements are met by using 1-1/2" of gypsum concrete or 1 or more layers of 7/16" OSB.

Check with local building code official regarding specific local requirements affecting installation of all building components.

1. Hardwood surface
2. 7/16" OSB
3. QuietFoam underlayment
4. QuietWood QW-631
5. 18" deep open-channel truss, 24" O.C.
6. Thermafiber SAFB insulation, 1-1/2"
7. Wood furring strips, 1" x 3"
8. QuietRock QR-530

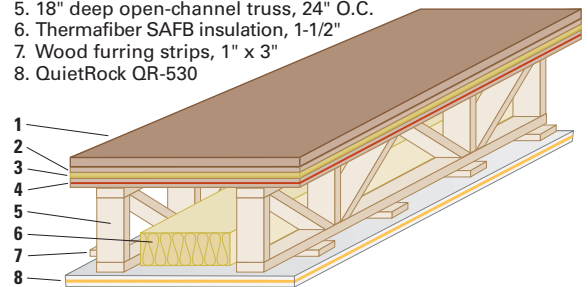

Physical Property Data

Size:	5' x 200' (1000 sq ft) roll
Type:	Closed cell foam
Thickness:	3/8"
Weight:	1 oz./sq ft, 62.5 lbs/roll
Color:	Light Yellow
Fire Rating:	ASTM E84: Class A
Flame Spread:	20
Smoke Developed:	250
Application:	Interior subfloor underlayment
Nominal Density	2.0 (pcf)
Water Absorption	<0.1 (psf)
Thermal Resistance	1.25 (HR-FT ² -°F/BTU)
Notes:	Keep Dry. Not for exterior use.



Quiet Solution
1250 Elko Drive
Sunnyvale, CA 94089

800-797-8159
info@QuietSolution.com
www.QuietSolution.com